

FEATURES

- Inexpensive
- Corrosion resistant
- Impervious to most chemicals
- Good heat resistance
- Injection-molded from custom-blended polypropylene
- Standard with Single Spring Clamp
- Optional Double Spring Clamps for pressures over 4.0 to 10 bar.
- Resists clogging
- Directional adjustment of nozzle tip anywhere within 45°
- Tips available in Full Cone, Hollow Cone or Flat Spray configurations
- Tips available with Threaded Ball Connection in 1/8", 1/4", 3/8" and 1/2" BSPT threads
- Nozzle bodies available in three spigot sizes to fit either 14 mm, 17 mm or 19 mm diameter holes on the riser

Mark 1 Adjustable Nozzle Assembly

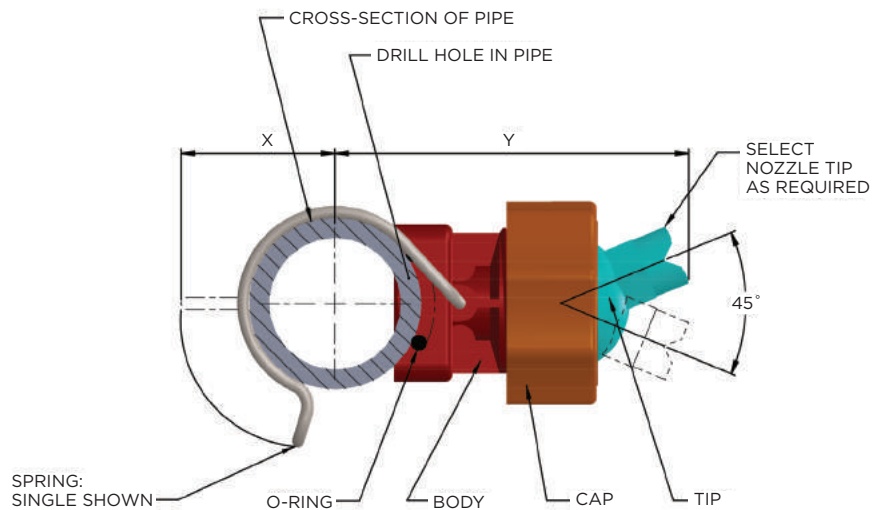

MAJOR DIMENSIONS

| Pipe size | X | Y | Reg. Spigot 17 mm | Sm Spigot 14 mm | Lg Spigot 19 mm |
|-----------|----|----|----------------------|--------------------|--------------------|
| 1" | 43 | 81 | Blue | Lt. Blue | Lt. Blue |
| 1-1/4" | 48 | 87 | Red | Pink | Pink |
| 1-1/2" | 51 | 90 | Purple | Mauve | Mauve |
| 2" | 57 | 95 | Green | Lime Green | Lime Green |

With a Single-Spring for pressures between 0 to 4.0 bar.
Also available with Double Springs for pressures from 4 to 10 bar.

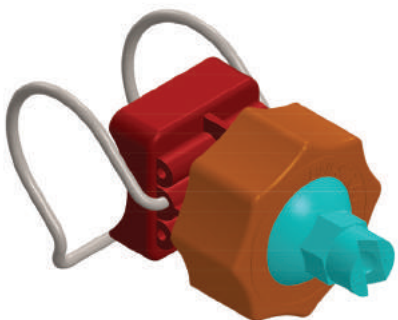

Established in 1987, Uni-Spray Systems Inc. is a global leader in nozzle pretreatment systems and product innovation.

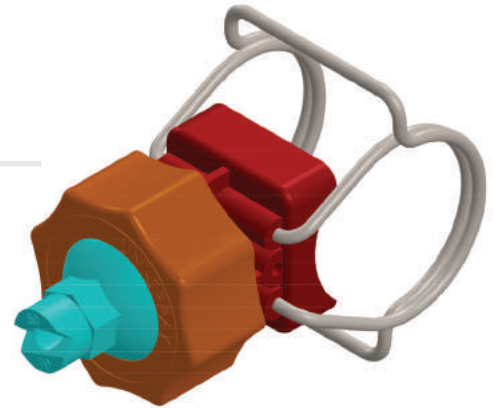

Mark 1 Adjustable Nozzle Assembly ORDERING INSTRUCTIONS

How to order a Mark 1 Adjustable Nozzle Assembly:

The complete Part Number tells us exactly what assembly you want.

For example, let's say that you want to order a Mark 1 Adjustable Nozzle Assembly to fit onto a DN32 (1 1/4") pipe, with a Single Spring, and with a 65° Flat Spray Nozzle Tip that will deliver 13 lpm at 2.0 bar:

STEP 1

The Part Number begins with UNI, followed by the pipe size:

| | | | | |
|------------------|---|------|---|----------|
| UNI 100 = 1" | - | DN25 | - | 32/34 mm |
| UNI 125 = 1-1/4" | - | DN32 | - | 41/43 mm |
| UNI 150 = 1-1/2" | - | DN40 | - | 48/50 mm |
| UNI 200 = 2" | - | DN50 | - | 60/63 mm |

So in our example, we would have so far

UNI 125

STEP 2

Select a Nozzle Tip from page 11 and add the Tip Number to the Part Number. In our example we now have

UNI 125 6540

Note that the 'UNI' in front of the Tip Number on page 11 is dropped when the Tip Number is incorporated into the Assembly Part Number.

STEP 3

Add M1 to denote the Style, which is standard with Single Spring. If you wanted a Double Spring, the Style would be M1 D.

So in our example, we end up with:

UNI 125 6540 M1

Note: Our standard Nozzle Assemblies are designed with spigots to fit risers with 17 mm diameter holes. We also manufacture assemblies with smaller spigots for 14 mm diameter holes and larger spigots for 19 mm holes. To specify the 14 mm spigots, simply change the 'UNI' in the part number to 'SS' for Small Spigot or LS for Large Spigot. For a Small Spigot, using the example above, the part number would become: SS 150 6540 M1.