

One-piece Structure Standard Flat Spray Nozzles

VVP/VP

Flat Spray

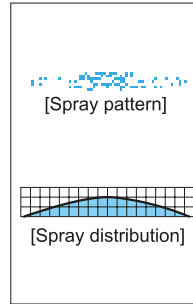

[Features]

- Flat spray pattern with a mountain-shaped spray distribution having gradually tapered edges.
- Tapered edges overlap to provide uniformity of spray distribution in multiple-nozzle arrangements.

[Standard pressure]

0.3 MPa

[Applications]

- Cleaning: Automotives, containers, films, felts, filters, screens, bottles, crushed stones, earth and sand, metal parts, machines, steel plates and pieces
- Spraying: Etchants, oils, lubricants, liquids, solutions, insecticides, herbicides
- Cooling: Gas, smokes, heat exchangers, tanks, steels, roofs
- Water screen: Fire protection, heat protection, dust suppression, deodorization

VVP series

VVP series	
Structure	<ul style="list-style-type: none"> • Made of metal or plastic, one-piece structure. • Small spray capacity models of metal VVP come with or without a strainer.
Material	<ul style="list-style-type: none"> • S303 or PP • S316L equivalent (precision-molded stainless steel)³ • Strainer for precision-molded stainless steel: S303 or S316 • Optional material: S316, PVC, PVDF, Ultrahigh molecular weight polyethylene, or others

Series	Pipe conn. size	Dimensions (mm)					Mass (g) ¹		
		L1	L2	H	øD	N	S303	S316L equiv.	PP
VVP ²	R1/8	18.5	31	12	7.5	6.5	10	—	—
	R1/4	25	40	14	10	10.5	21	—	—
	R3/8	30	—	19	—	10.5	37	—	—
	R1/2	38	—	23	—	14	65	—	—
	R3/4	45	—	29	—	15	110	—	—
	R1	55	—	35	—	18	170	—	—
VVP ³ (Precision-molded stainless steel)	R1/8	20	33.5	12	7.5	7	—	9.6	—
	R1/4	27	41	14	10	10.5	—	16	—
VVP-PP (Injection molded)	R1/8	22	—	12	—	8.5	—	—	1.1
	R1/4	27	—	14	—	11.5	—	—	2.2

*1) With a strainer, add 2–5 g to the above mass.

*2) VVP with spray capacity code of 20 or smaller slightly differs in dimensions (L1, L2) and in shape of nozzle tip from the above. Contact us for details.

*3) Please see the chart on page 20 for availability.

[Note] Appearance and dimensions may differ slightly depending on materials and nozzle codes.

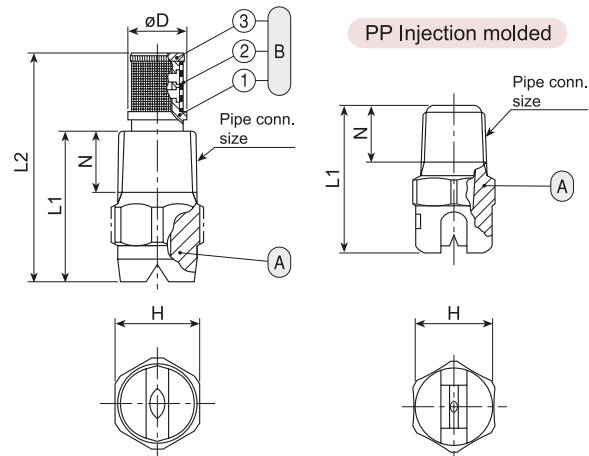

- Ⓐ Nozzle
 Ⓑ Strainer (① Strainer holder ② Strainer screen [S316] ③ Strainer cap)

Precision-molded stainless steel

R1/8"

R1/4"

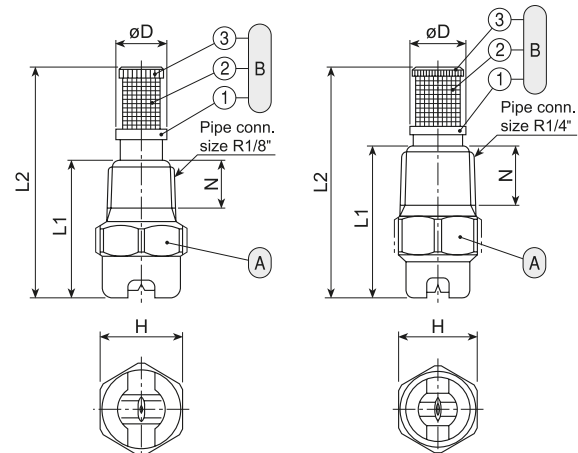

- Ⓐ Nozzle
 Ⓑ Strainer (① Strainer holder ② Strainer screen [S316] ③ Strainer cap)

